

CH

The Original CH multi-purpose Strip Lights are offered in a variety of sizes and lamp configurations for a custom lighting design. Patented, laborsaving, flip-up sockets simplify installation.

Project _____
 Catalog Number _____
 Type _____
 Date _____

HOUSING Die-formed heavy gauge steel with high-gloss, baked white enamel finish over rust inhibiting phosphate coat with removable wireway access panel. Ample knock outs provided on side, back and ends. Shipped fully wired and assembled, including socket saddle. Simply flip up socket bar and attach wireway cover with turn fastener provided. Machine installed shunts eliminate loose socket bar connections on electronic strips.

OPTIONS Modular wiring, white or silver asymmetric or symmetric reflectors, and emergency lighting battery packs are available options.

ELECTRICAL Fully wired Universal 120-277V, 50-60Hz operation with thermally protected, automatic resetting Class P, sound rated A ballast as standard unless otherwise specified.

MOUNTING Combination end plate/joiner connect units for continuous row or wire through, use CHJ. Optional plug-in wiring system available.

LISTINGS C-UL-US Listed damp location.

WARRANTY 1 year limited warranty.

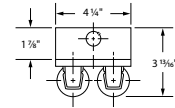

CH Striplite Configuration

SERIES	# LAMPS	LAMPS*	ELS OPTIONS	BALLAST	SWITCHING	VOLTAGE
CH	1	14 = 14W 15" T12	ELS1 = Emergency Lighting (T8 500 lm, T5 700 lm) ELS2 = Emergency Lighting (T8 700 lm, T5 700 lm) ELS3 = Emergency Lighting (T8 1400 lm, T5 1400 lm)	B5 = Electronic T12 B11 = Electronic T8 B11HP(x) = HP T8* BRES11 = T8** B12 = Electronic T12 B14 = Electronic TT B22 = LFP T8/T12*** D = Dimming (Specify Ballast) CS = Customer Supplied B9 = Customer Specified	<i>For 2 lamp units:</i> Blank = One 2-lamp ballast 2/1L = Two 1-lamp ballasts <i>For 4 lamp units:</i> Blank = Dual Ballasts 4L = (1) 4-lamp ballast	UNV = 120-277V 120 = 120V 277 = 277V
	2	14 = 14W 24" T5				
	4	15 = 15W 18" T8/T12				
		17 = 17W 24" T8				
		20 = 20W 24" T12				
		21 = 21W 36" T5				
		24 = 24W 24" T5HO				
		25 = 25W 36" T8				
		28 = 28W 48" T5				
		30 = 30W 36" T12				
		32 = 32W 48" T8				
		39 = 36W 36" T5HO				
		40 = 34/40W 48" T12				
	40TT = 40W 22" TT T5					
	54 = 54W 48" T5HO					

*CEE listed T8; specify (L)ow, (N)ormal, or (H)igh ballast factor. Contact factory for NEMA Premium.
 **For 2 and 4 lamp 32W Energy Star fixtures
 ***Fixtures with B22 are UL only

OPTIONS	ACCESSORIES
Cord and Plug CPT(x) (Twist + Lock) 1 = 120V 2 = 277V CP3 = Cord & Plug - 120V Straight blade 5-15P Plug-in connectors <i>Ballast wired to Black:</i> PL1 = One circuit, two wires PL2 BK = Two circuits, three wires <i>Ballast wired to Red:</i> PL2 RD = Two circuits, three wires FB = Fast blow fuse SB = Slow blow fuse BP = Bulk Pack	Reflectors (Not compatible with wire guards) <i>Symmetric</i> SR(x)(y)20 = 24" SR(x)(y)30 = 36" (Order 2 for tandem 72" units) SR(x)(y)40 = 48" (Order 2 for tandem 96" units) <i>Asymmetric</i> AR(x)20 = 24" AR(x)30 = 36" (order 2 for tandem 72" units) AR(x)40 = 48" (order 2 for tandem 96" units) (x) enter (W) for white or (S) for specular aluminum (y) enter # lamps (1 or 2) AC = alignment Clips CA24 = Chain Hanger assembly - (2) 18" chains, (2) "V" hooks, (2) "S" hooks for total drop 24" CS24 = "S" Hook (4) Chain Hanger assembly (24" total drop) PM(x) = Pendant mount, white stem - specify length in inches (24, 36, 48, 60, 72) C = Single white canopy (for use with pendant mount) CHJ = Housing Joiner SN = Snapper brackets (2 lamp and 4 lamp tandem models only) WG(x)20 = 24" (Specify # lamps) (1 or 2) WG(x)30 = 36" (Specify # lamps) (1 or 2) WG(x)40 = 48" (Specify # lamps) (1 or 2)

Dimensions

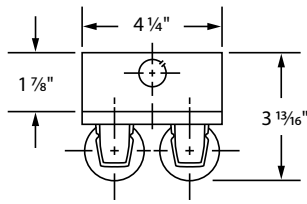

CH

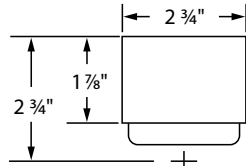

CHTT

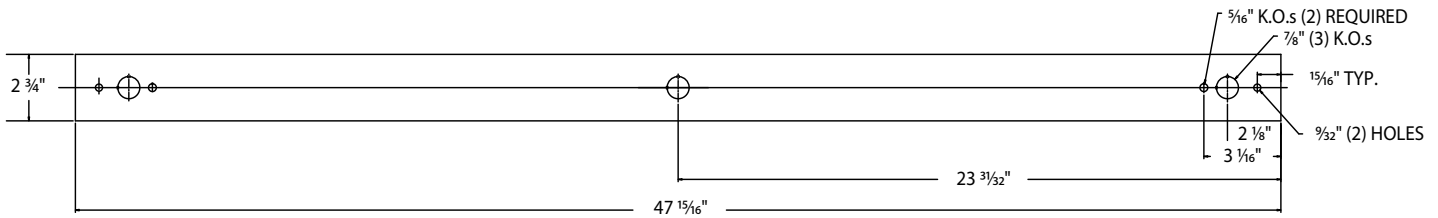
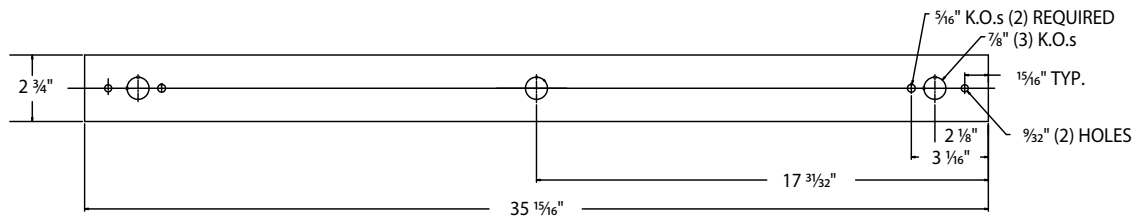
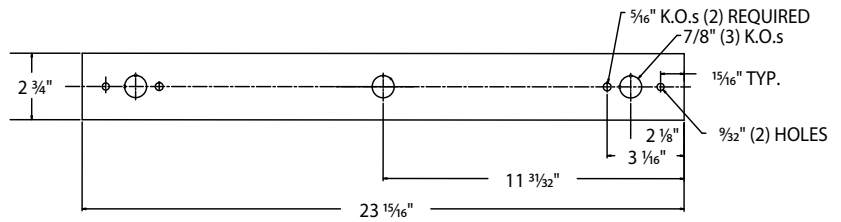
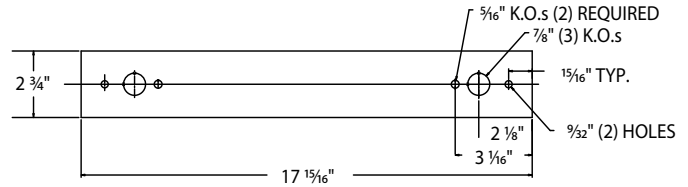
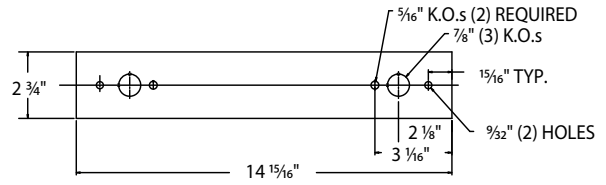

Dimensions

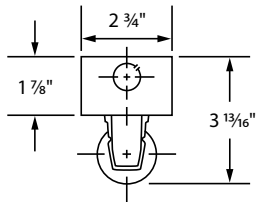
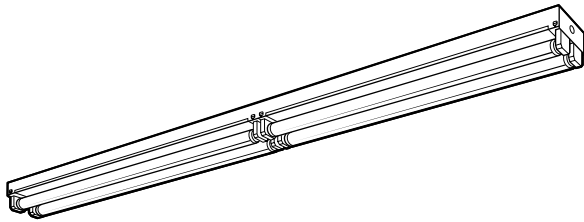
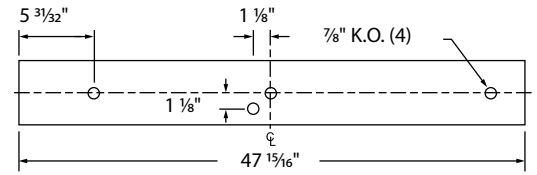
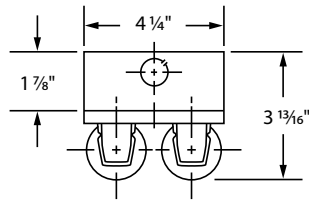
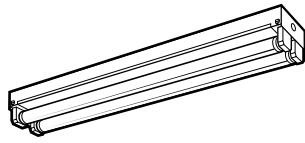

**CH
1 Lamp**

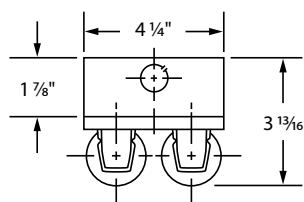

**CH
2 Lamp**

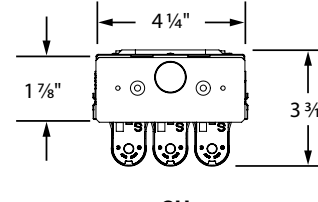

**CH
3 Lamp**

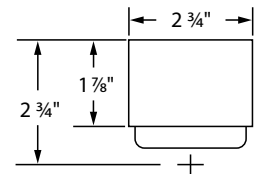

CHTT

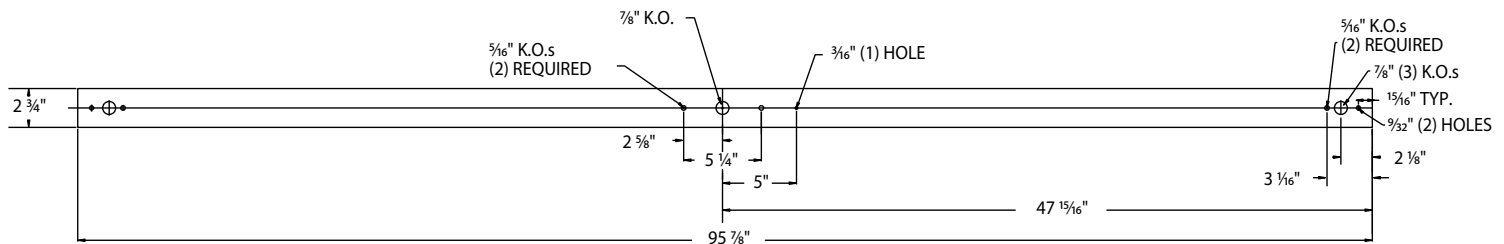

1 LAMP MODELS

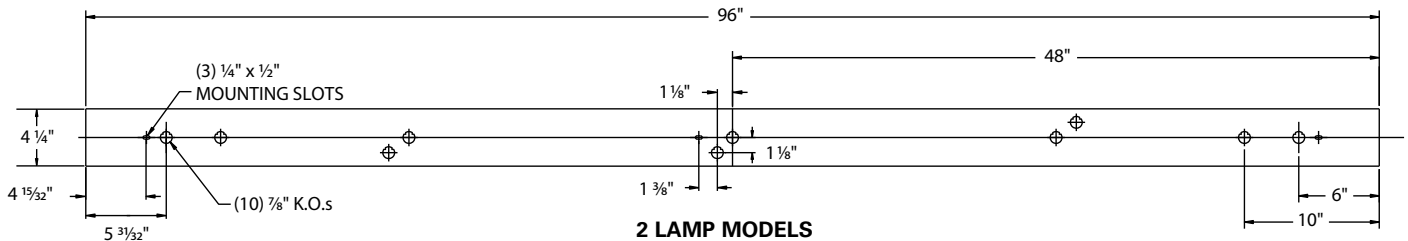

2 LAMP MODELS