

Shunt release 20...24 V AC, 50/60 Hz, 100% ON period 20-70 V AC, 50/60 Hz, 5 s ON period 20-70 V DC, 5 s ON period with screw terminal for circuit breaker 3RV2

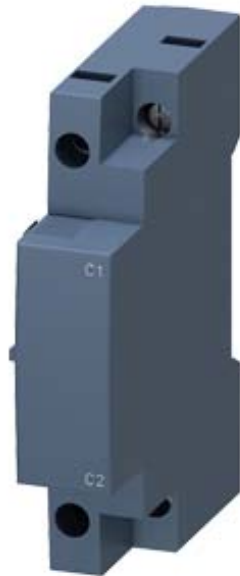

General technical data	
Product brand name	SIRIUS
Product designation	shunt release
Size of the circuit-breaker	S00, S0, S2, S3
Suitability for use	motor circuit breaker
Protection class IP on the front	IP20
Design of short-circuit protection	fuse
Degree of pollution	3
Insulation voltage rated value	690 V
Insulation voltage with degree of pollution 3 rated value	690 V
Ambient temperature	
• during storage	-50 ... +80 °C
• during operation	-20 ... +60 °C
Reference code acc. to DIN 40719 extended according to IEC 204-2 acc. to IEC 750	F
Reference code acc. to DIN EN 61346-2	F

### Auxiliary circuit

Number of NC contacts for auxiliary contacts instantaneous contact	0
Number of NO contacts for auxiliary contacts instantaneous contact	0
Number of NO contacts for auxiliary contacts leading contact	0
Number of CO contacts of auxiliary contacts instantaneous contact	0

#### Control circuit/ Control





<b>Type of voltage of the control supply voltage</b>	AC
<b>Control supply voltage frequency</b>	
<ul style="list-style-type: none"> <li>• 1 <ul style="list-style-type: none"> <li>— Initial rated value</li> <li>— Final rated value</li> </ul> </li> </ul>	50 Hz 60 Hz
<b>Control supply voltage</b>	
<ul style="list-style-type: none"> <li>• 1 <ul style="list-style-type: none"> <li>— at AC <ul style="list-style-type: none"> <li>— at 50 Hz Initial rated value</li> <li>— at 50 Hz Final rated value</li> <li>— at 60 Hz Final rated value</li> <li>— at 60 Hz Initial rated value</li> </ul> </li> </ul> </li> </ul>	20 V 24 V 24 V 20 V

#### Installation/ mounting/ dimensions



<b>Mounting type</b>	snap-on mounting
<b>Width</b>	18.5 mm
<b>Height</b>	90 mm
<b>Depth</b>	68 mm

#### Certificates/approvals

<b>Certificate of suitability</b>	CE / UL / CSA
-----------------------------------	---------------

General Product Approval		Declaration of Conformity		Test Certificates
				<a href="#">Miscellaneous</a> <a href="#">Type Test Certificates/Test Report</a>

Test Certificates	Shipping Approval				
<a href="#">Special Test Certificate</a>					

Shipping Approval	other	Railway
	<a href="#">Confirmation</a>	<a href="#">Vibration and Shock</a>
		

#### Further information

##### Information- and Downloadcenter (Catalogs, Brochures,...)

<http://www.siemens.com/industrial-controls/catalogs>

##### Industry Mall (Online ordering system)

<https://mall.industry.siemens.com/mall/en/en/Catalog/product?mlfb=3RV2902-1DB0>

##### Cax online generator

<http://support.automation.siemens.com/WW/CAXorder/default.aspx?lang=en&mlfb=3RV2902-1DB0>

##### Service&Support (Manuals, Certificates, Characteristics, FAQs,...)

<https://support.industry.siemens.com/cs/ww/en/ps/3RV2902-1DB0>

##### Image database (product images, 2D dimension drawings, 3D models, device circuit diagrams, EPLAN macros, ...)

[http://www.automation.siemens.com/bilddb/cax\\_de.aspx?mlfb=3RV2902-1DB0&lang=en](http://www.automation.siemens.com/bilddb/cax_de.aspx?mlfb=3RV2902-1DB0&lang=en)

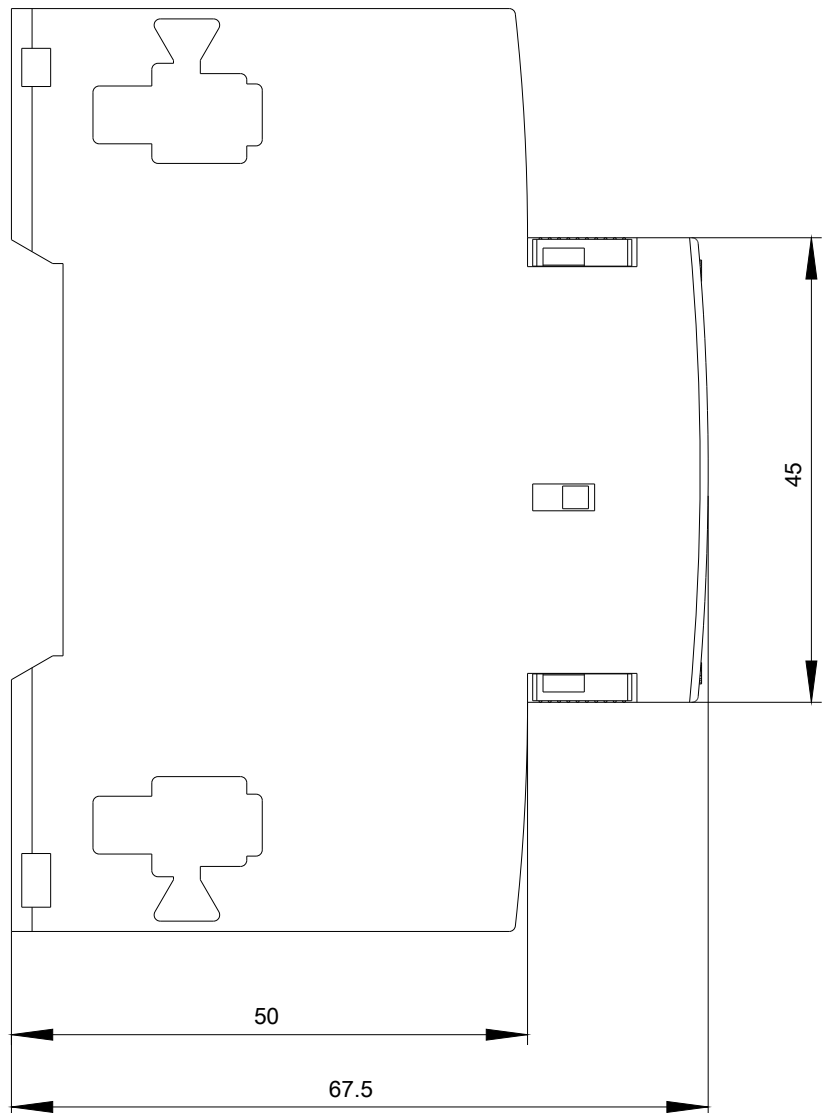
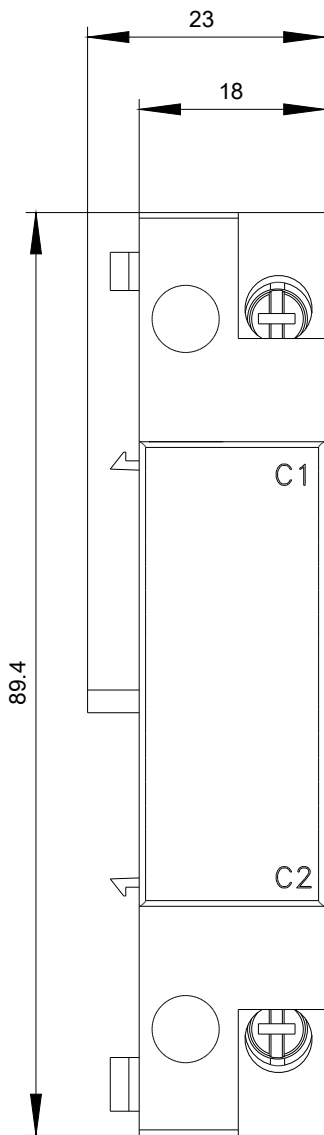

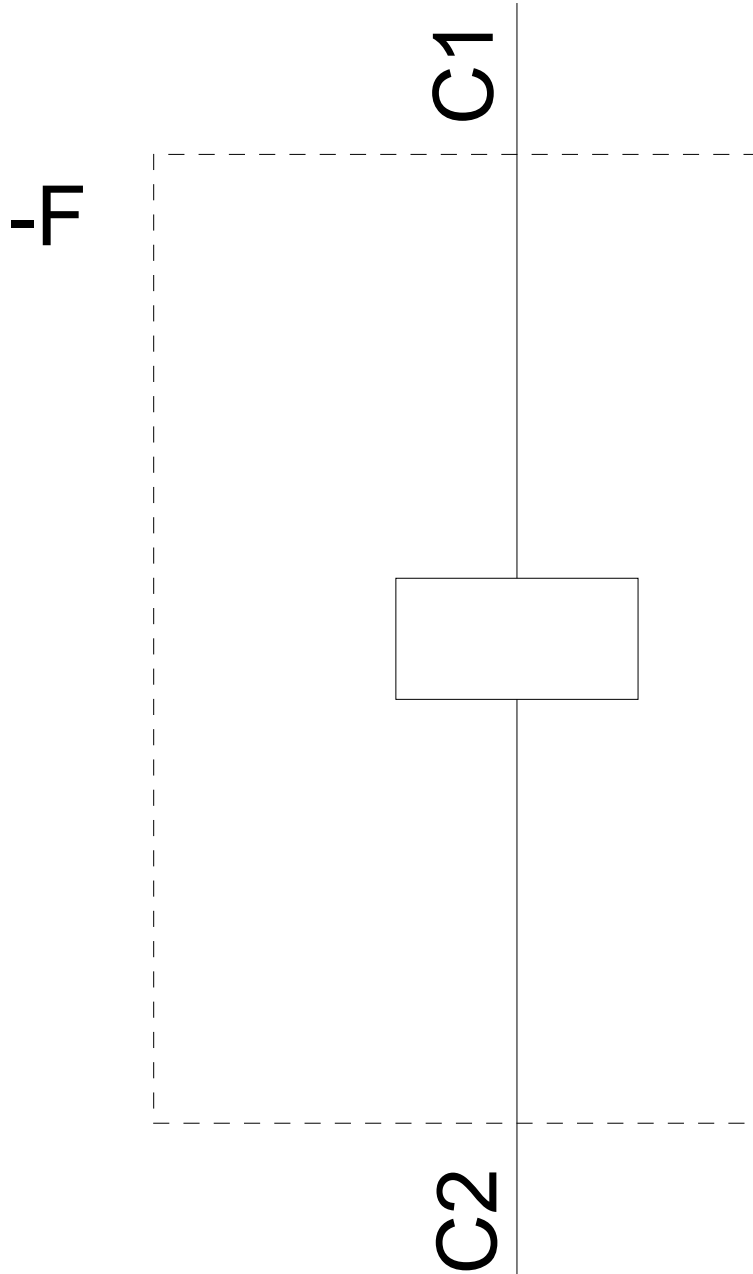

last modified:

05/03/2019