

Cooling Fan Package, Type 1  
Ventilateur de refroidissement, Type 1  
Paquete de Ventilador, Tipo 1

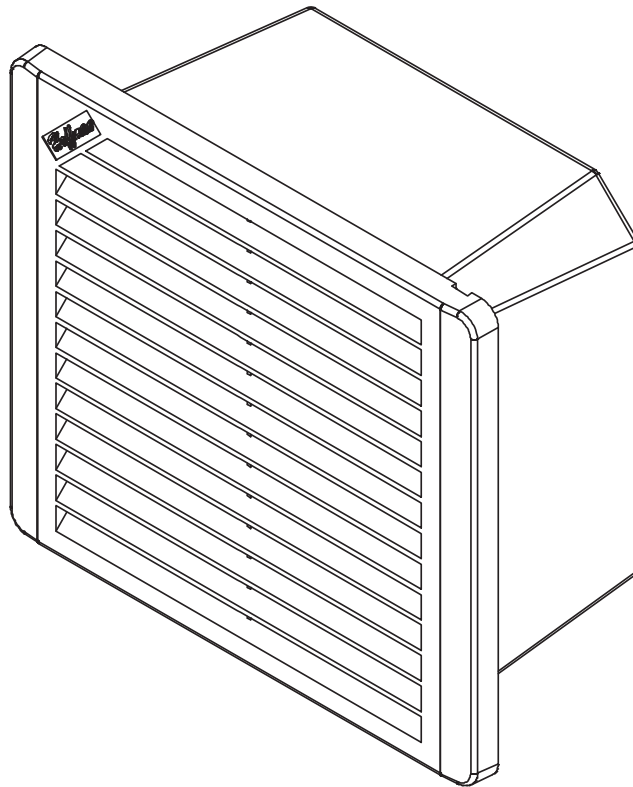

## Introduction

1. Before installing cooling fan package, read these instructions carefully. Failure to follow these instructions could damage the product or cause a hazardous condition.
2. Check the ratings on the fan label to assure the product is suitable for your application. Catalog numbers TFP41, TFP61, and TFP101 operate on 115 VAC, 50/60 Hz, single phase input power. Catalog numbers TFP42, TFP62, and TFP102 operate on 230 VAC, 50/60Hz, single phase input power. Catalog Numbers TFP424 and TFP624 operate on 24 VDC.

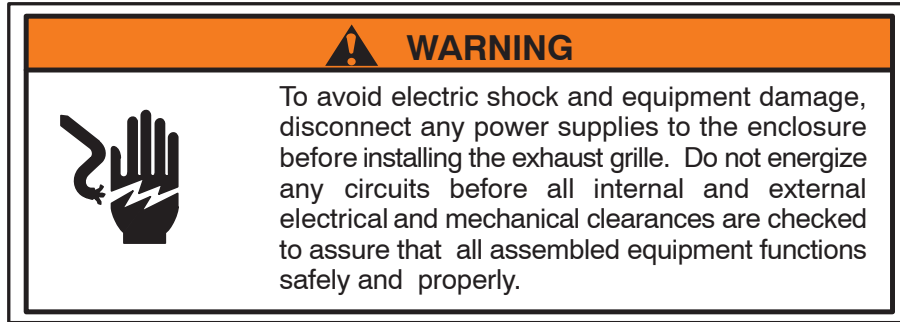

## General safety information

1. Protect the fan power cord (or lead wires) from coming in contact with sharp objects, hot surfaces, and/or chemicals.
2. If continuous operation of the fan is essential to the safe functioning of any other equipment, adequate warning devices must be installed to assure safe operation at all times. Hoffman temperature switch (catalog number ATEMNO) can be used to activate an alarm or warning light to indicate high enclosure temperatures. This temperature switch can also be used to cycle the cooling fans as cooling requirements change.







## Wiring

1. All wiring must comply with applicable local codes and ordinances.
2. Connect the two fan leadwires to the proper voltage power source.
3. All fan wires should be strain relieved with tension clips.

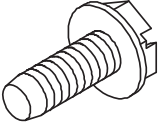
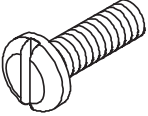
## Maintenance

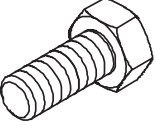
1. Always disconnect power supply before inspecting or working on the fan package.
2. Generally the fan unit requires no maintenance since the bearings are permanently lubricated and sealed. The fan cannot be field serviced; it should be replaced if defective.
3. The foam filter inside the fan package should be periodically removed and washed with soap and warm water to keep it clean.

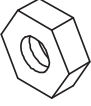
<p>1                      10-32x.50</p>  <p>(2x) (8x)</p>	<p>2                      8-32x.50</p>  <p>(4x)</p>
<p>3</p>  <p>(4x)</p>	<p>4                      M5x12</p>  <p>(4x)</p>
<p>5</p>  <p>(4x)</p>	<p>6                      No. 8</p>  <p>(4x)</p>

Exhaust Grille (order separately)  
 Grille d'échappement (commander séparément)  
 Rejilla de Salida de Aire (Ordenar por Separado)

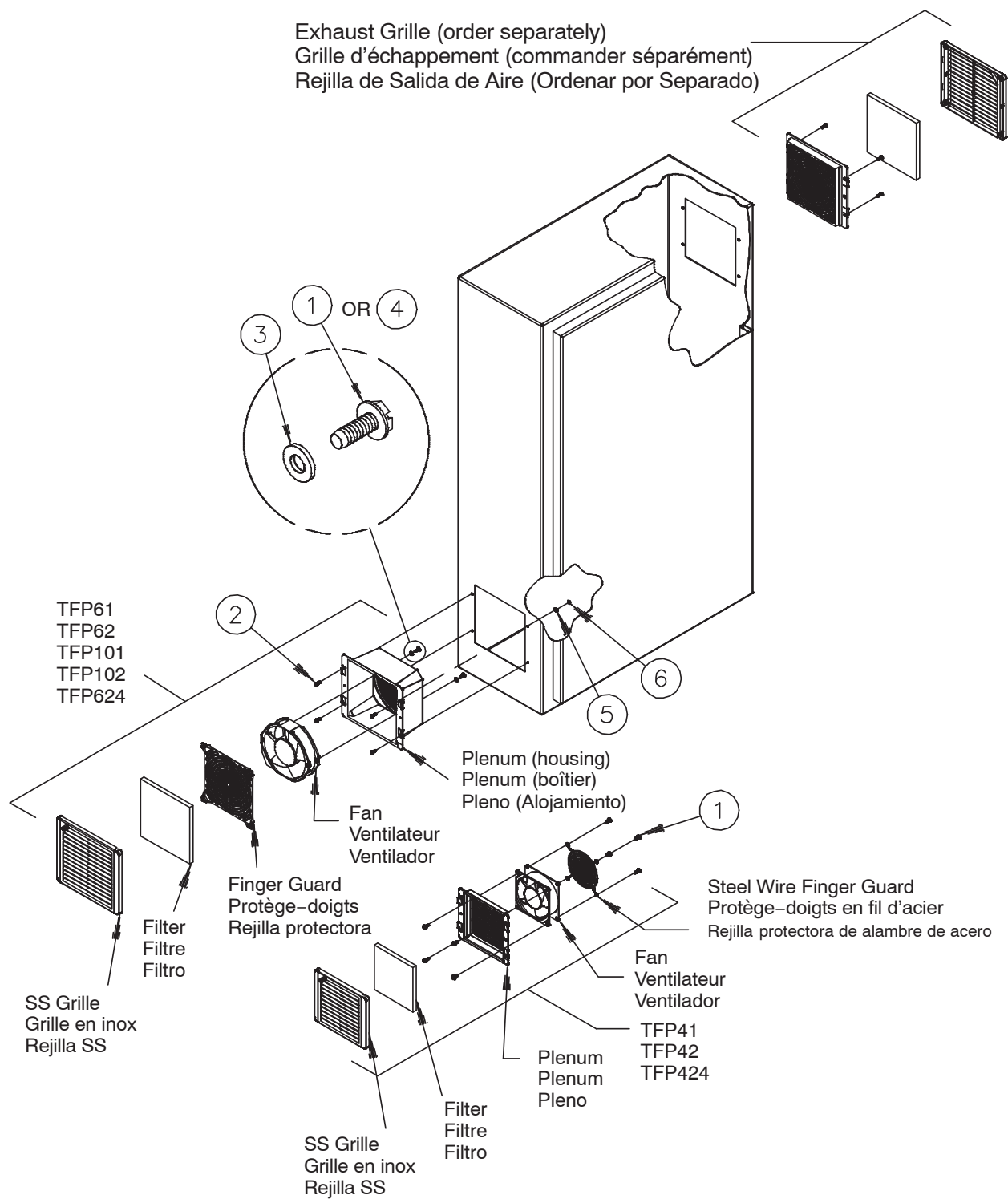

## Location and Mounting

1. Determine the fan package location on the enclosure. This location depends on the available space within the enclosure and on the airflow pattern desired. Allow clearance for the enclosure and electrical panel and mounting studs. Follow the general fan package application guidelines outlined in the Hoffman catalog.
2. UL Arc Barrier Requirement: If a ventilation opening is less than 12 inches (305 mm) from an arcing part, a barrier shall be interposed between the ventilation opening and a possible source of arcing, such as a power-circuit switch, a fuse, the vent openings of a circuit breaker, a conductor, or an overload relay.

Barrier Material	Minimum Thickness	
Steel	0.053 in.	1.35 mm
Aluminum	0.075 in.	1.9 mm
Polycarbonate	0.125 in.	3.2 mm
Other Non-metallic	0.250 in.	6.35 mm

A barrier shall be of such dimension and so located that any straight line drawn from any arcing part past the edge of the barriers intersects a point in the ventilation opening plane that is at least 0.25 inches (6.35 mm) outside the edge of the ventilation opening.

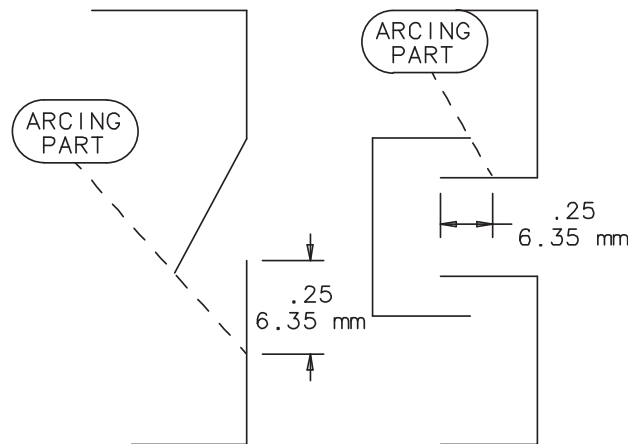

A barrier shall be secured in place by mechanical means such as mechanical fasteners.

3. Clear all wires and components out of the way and make the proper size cutout. See the following hole pattern and table.
4. If electrical grounding is required, ground the fan housing using a lead wire sized per N.E.C. standards. Use the green grounding screw provided to connect the separate ground wire (not supplied) to the fan grounding pad.
5. Establish the airflow direction through the fan. Arrows marked on the fan housing indicate the airflow direction and the blade rotation.
6. Guide the lead wires and grounding wire through the wire access hole in the rear wall of the plenum. (models TFP61, TFP62, TFP101, TFP102, TFP624 only)
7. Mount the fan to the plenum with the supplied thread cutting screws and washers.
8. For models TFP41, TFP42, TFP424 only, mount the steel wire finger guard to the fan with the supplied thread cutting screws.
9. Insert the assembled fan package into the enclosure cutout as shown.
10. Secure the fan package in place using the supplied screws, lockwashers, and nuts.
11. Snap in the finger guard and insert the filter over the guard. (models TFP61, TFP62, TFP101, TFP102, TFP624) Place the filter inside the plenum. (models TFP41, TFP42, TFP424)
12. Snap the composite grille over the fan package.

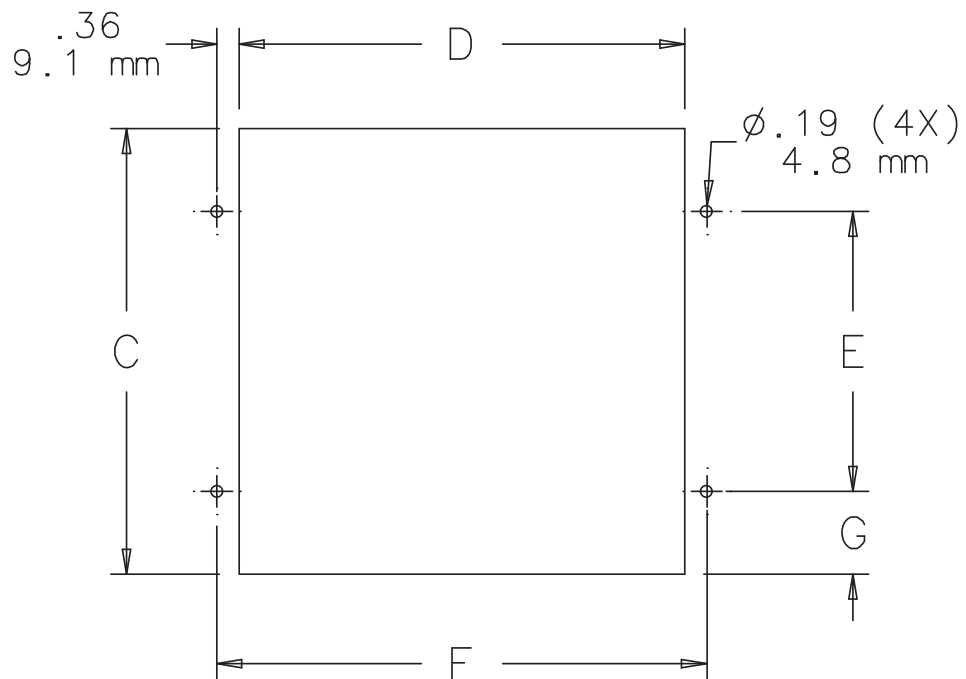

Catalog Number	C	D	E	F	G
TFP41 TFP42 TFP424	5.66 (144mm)	5.66 (144mm)	4.12 (105mm)	6.39 (162mm)	.77 (20mm)
TFP61 TFP62 TFP624	7.16 (182mm)	7.16 (182mm)	4.50 (114mm)	7.89 (200mm)	1.33 (34mm)
TFP101 TFP102	11.16 (283mm)	11.16 (283mm)	6.88 (175mm)	11.89 (302mm)	2.14 (54mm)

**Grille Removal**  
**Retrait de la grille**  
**Retiro De la Rejilla**

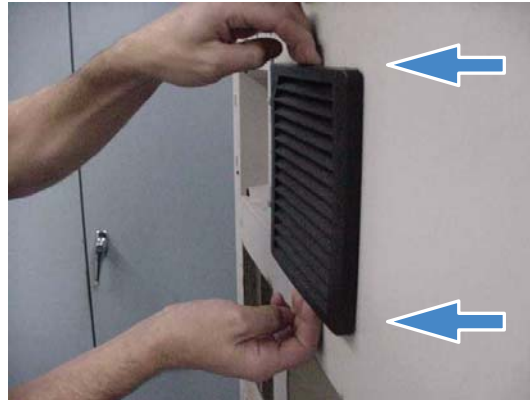

1. Grasp the top and bottom of the grille.  
Saisir les parties supérieure et inférieure de la grille.  
Agarre la rejilla de la parte superior e inferior como lo muestra la foto.

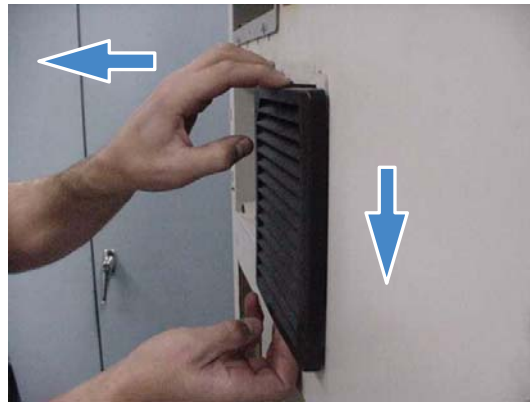

2. While pulling out, push down.  
Tirer vers l'extérieur et le bas en même temps.  
Mientras esta sacando la rejilla, empuje hacia abajo al mismo tiempo.



3. Grille releases.  
La grille se dégage.  
La rejilla estará desprendida



A Pentair Company

**HOFFMAN** (World Headquarters)  
2100 Hoffman Way  
Anoka, MN 55303-1745 USA  
(763) 421-2240 Fax: (763) 422-2178  
Customer Service: (763) 422-2211  
[www.hoffmanonline.com](http://www.hoffmanonline.com)

***Canada***

**HOFFMAN**

111 Grangeway Avenue  
Suite 504  
Scarborough, Ontario M1H 3E9  
(416) 289-2770 Fax: (416) 289-2883  
1-800-668-2500 (Canada only)

***Mexico***

**HOFFMAN MEXICO, S de RL de CV**

Arquímedes No. 33  
Piso 1  
Col. Palmas Polanco  
México, DF  
CP 11560  
P: (55) 5280-1596  
F: (55) 5280-8827 / 5280-8167