

MASS: .986 LBS
 CAT. NO.: IPC-350-350 & IPC-350-350-B

TOLERANCES-UNLESS OTHERWISE SPECIFIED
 2 PL. DEC. ±.015 TRUE C.L. ±.015
 3 PL. DEC. ±.015 ANGLES ±1

DWG. NO.
K0429
 SHEET 1 OF 1



DRAWN BY: JG SCALE: 1=1
 DATE: 2/5/2008 SIZE: A

REV.	DESCRIPTION
K	

DESCRIPTION	IPC-350-350 K0429W00TI		IPC-350-350-B K0429W01TI	
	COMPONENT	QTY/EA	COMPONENT	QTY/EA
MOLDED BODY (TOP AND BOTTOM)	130094	1	130094	1
TOP PLATE (ZN PLATED)	130098	1	130098	1
TEETH (SN PLATED/BRBD)	130116	8	130116	8
BOTTOM PLATE (ZN PLATED/TAPED/DRILLED)	130101	1	130101	1
TAP LABEL	100151A	1	100151A	1
RUN LABEL	100151	1	100151	1
BOLT M10 X 1.5 X 2 7/8"	130072	2	130072	2
BOX	100324	.250	CCR0512	.500
INSTALLATION INSTRUCTION	FORM 70	.250	FORM 70	.250
GREASE (SILICONE DIELEC CPD)	130240	.009	130240	.009
PLASTIC BAG			CBR1427	1

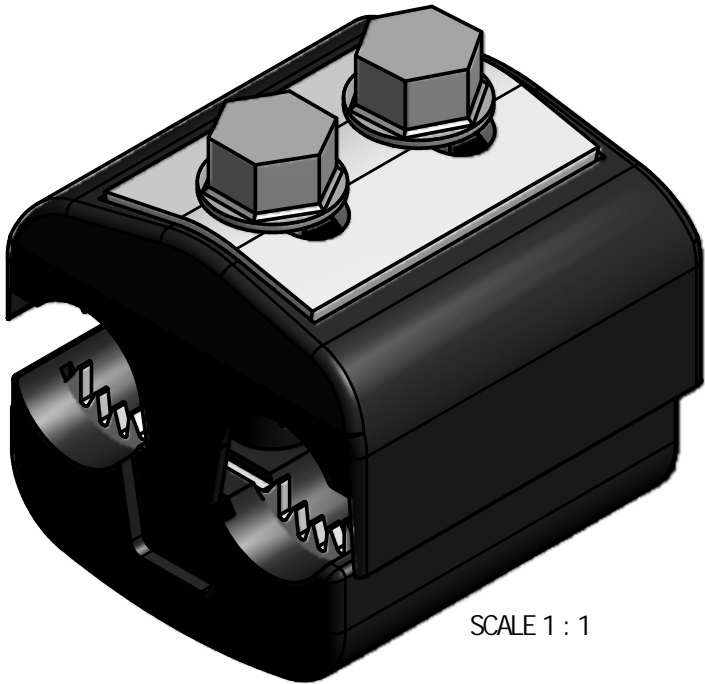

SCALE 1 : 1