



# Core & Coil (71A) MH < 175W

## CORE & COIL HID MH BAL 100W 90/140 QUAD KIT

The basic ballast is the open core and coil which is most often used as a component within a lighting luminaire. The core and coil also forms the nucleus of Philips Advance's five other ballast configurations.

### Product data

#### • General Characteristics

Lamp Type	100 MH
Number of Lamps	1 piece
Line Voltage	120/208/240/277 V
Input Current (Operating)	1.15/0.66/0.58/0.5 A
Line Frequency	60 Hz
Circuit Type	HX-HPF
Ballast Type	Magnetic HID
Base Model	71A5390
Core Size	3 X 4 (2 LW)
Suitable for Outdoor use?	Yes
Ignitor Catalog Number	LI533-H4
Ignitor Temp Rating	105°C
Capacitor value [µF]	12 MFD
Capacitor Catalog Number	7C120M30RA
Capacitor Requirements	280V
Capacitor Temp Rating	105°C
Capacitor Dia/Oval Dim	1.65 in
Capacitor Height	2.75 in
Family Name	Core & Coil MH

#### • Operating Characteristics

Automatic restart	No
Input Voltage at Lamp Dropout	90/156/180/208 V
Nominal Open Circuit Voltage	260 V
Inp. Current (Open Circuit)	2.5/1.5/1.3/1.12 A

Input Current (Starting)	1.24/0.54/0.45/0.4 A
Input Current Short Circuit	0.63-0.95/0.43-0.65/0.37-0.55/0.29-0.4 A
Secondary ShortCircuit Current	1.35-1.7 A
Input Power Gear	129 W
Constant wattage deviation	12%
Ballast factor	1 -
Power Factor	0.90

#### • Wiring Characteristics

Wire Striplength	0.5 mm
Wire Length by Color	12"
Wire Type	Stranded
Allowed Wiring Config(Remote)	Yes
Max Dist. Ball to Lamp(Remote)	20'
Recommended Fuse	10/5/5/4 A

#### • System Chars on driver level

Rated Lamp Watts	100W
------------------	------

#### • Product Dimensions

Length A1	3.9 in
Length A2	3.5 in
Width B1	2.8 in
Coil Depth C1	3.07 in
Stack Height C2	1.5 in
Width B2	2.4 in

**PHILIPS**

## Core & Coil (71A) MH < 175W

### • Approval & Application Chars

Approbation Marks	ULR, CSA, RoHS
CE marking	No
VDE certificate	No
UL Listed	No
CSA certificate	Yes
CCC certificate	No
China Quality Certificate	No
Temperature marking	B/B/A/A
CEC Listing	No
cUL certificate	No
EISA	No
ETL Certificate	No
FIDE Certificate	No
NOM certificate	No
RoHS Compliant	Yes
SASO Certificate	No
UL Recognized	Yes
ANSI Code	M90/M140

HiPot Test (1 minute)	2000 V
HiPot Test (2 seconds)	2500 V
Open Circ Voltage Test (Volts)	240-300 V
UL Insulation Class	H(180°C)
UL Temperature Code	1029B

### • Product Data

Product number	71A5390001D
Full product name	MH BAL 100W 90/140 QUAD KIT
Short product name	MH BAL 100W 90/140 QUAD KIT
Pieces per Sku	1
Skus/Case	1
Bar code on pack	781087017838
Bar code on case	30781087017839
Logistics code(s)	913700533009
eop_net_weight_pp	2.541 kg

### Dimensional drawing

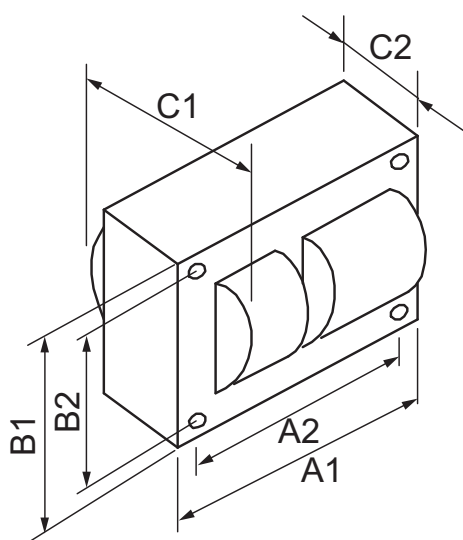

### CORE & COIL HID MH BAL 100W 90/140 QUAD KIT

Product	A1 (Norm)	A2 (Norm)	B1 (Norm)	B2 (Norm)	C1 (Norm)	C2 (Norm)
MH BAL 100W 90/140 QUAD KIT	3.9	3.5	2.8	2.4	3.07	1.5

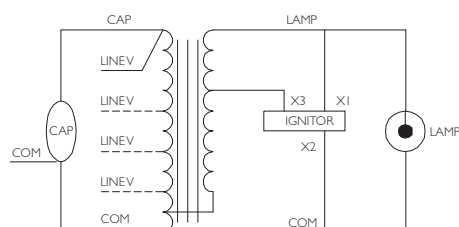

© 2014 Koninklijke Philips N.V. (Royal Philips)  
All rights reserved.

Specifications are subject to change without notice. Trademarks are the property of Koninklijke Philips N.V. (Royal Philips) or their respective owners.

[www.philips.com/lighting](http://www.philips.com/lighting)

2014, March 26  
data subject to change