

Core & Coil (71A) MH 175W - 450W

CORE & COIL HID 71A5540001D

The basic ballast is the open core and coil which is most often used as a component within a lighting luminaire. The core and coil also forms the nucleus of Philips Advance's five other ballast configurations.

Product data

General Information	
ANSI Code	M57-M107
Lamp Type	175/150W MH
Number Of Lamps	1 piece/unit
Circuit Type	CWA
Ballast Type	Magnetic HID
Base Model	71A5540
Core Size	3 X 4 (2 coil)
Suitable For Outdoor Use	Yes
Ignitor Catalog Number	NA
Ignitor Temperature Rating	NA
Capacitor Value	10 MFD
Capacitor Catalog Number	7C100M40R
Capacitor Requirements	400V
Capacitor Temperature Rating	105°C
Capacitor Diameter/Oval Dimensions	1.45 in
Capacitor Height	3.75 in
Automatic Restart	No

Operating and Electrical	
Input Voltage	480 V
Input Frequency	60 Hz
Power (Rated) (Nom)	175/150 W
Input Current (Open Circuit)	0.45 A
Input Current (Starting)	0.35 A
Input Current (Short Circuit)	0.15-0.3 A
Secondary Short Circuit Current	1.5-1.9 A
Constant Wattage Deviation	10%
Ballast Factor (Nom)	1
Power Factor (Nom)	0.90
Open Circuit Voltage	305 V
Input Current (Nom)	0.45 A A
Input Power (Nom)	210 W
Rated Lamp Power	175/150W W

Wiring	
Wire Striplength	0.5 mm
Wire Length By Color	12"
Wire Type	Stranded

Core & Coil (71A) MH 175W - 450W

Remote Wiring Configuration Allowed	Yes
Max Ballast-Lamp Distance Remote Wiring	Determined by AWG used
Recommended Fuse Value	2 A

Approval and Application

Open Circuit Voltage Test (Volts)	275-335 V
Approval Marks	ULR CSA certificate RoHS Compliant
Temperature Marking	D
UL Recognized	Yes
Hipot Test (1 Minute)	2000 V
Hipot Test (2 Seconds)	2500 V
UL Insulation Class	H(180°C)

UL Temperature Code	1029D
---------------------	-------

Product Data

Order product name	CORE & COIL HID 71A5540001D
EAN/UPC - Product	781087096444
Order code	913700565809
Numerator - Quantity Per Pack	1
Numerator - Packs per outer box	1
Material Nr. (12NC)	913700565809
Net Weight (Piece)	3.439 kg

Dimensional drawing

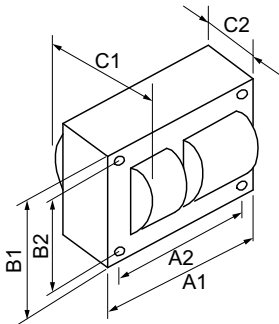

MH BAL 175W M57 480V KIT

Product	C1	C2	A1	A2	B1	B2
---------	----	----	----	----	----	----

